

## - Valve Ball & Seat

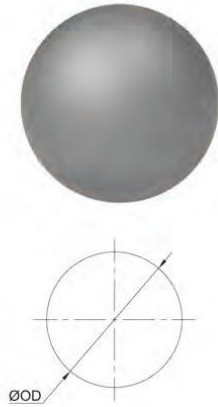

### Valve ball

Unit: mm

API type	Stock No.	Size	OD	
V11-106	VQ115801	5/8"	Ø15.9	+0.9 +0.6
V11-125	VQ119001	3/4"	Ø19.1	+1.0 +0.8
V11-150	VQ123801	15/16"	Ø23.8	+1.0 +0.8
V11-175	VQ128501	1-1/8"	Ø28.6	+1.1 +0.8
V11-200	VQ131701	1-1/4"	Ø31.8	+1.5 +1.0
V11-225	VQ134901	1-3/8"	Ø34.9	+1.5 +1.0
V11-250	VQ142801	1-11/16"	Ø42.9	+1.5 +1.0
V11-375	VQ157101	2-1/4"	Ø57.2	+1.8 +1.3

### Valve seat

Unit: mm

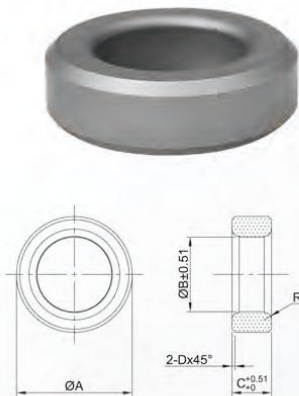

API type	Stock No.	Size	A	B	C	D	R
V11-106	VS10201101201	1-1/16"	Ø20.4 +0.5 +0	Ø11.7	13.0	1.0	1.6
V11-125	VS10231301201	1-1/4"	Ø23.6 +0.5 +0	Ø14	13.0	1.0	1.6
V11-150	VS10291701201	1-1/2"	Ø29.9 +0.5 +0	Ø17	13.0	1.3	2.0
V11-175	VS10352001201	1-3/4"	Ø35.5 +0.5 +0	Ø21	13.0	1.5	2.4
V11-200	VS10372401201	2"	Ø37.8 +0.5 +0	Ø24.4	13.0	1.5	2.4
V11-225	VS10432601201	2-1/4"	Ø43.9 +0.6 +0	Ø26.9	13.0	2.0	2.4
V11-250	VS10513301201	2-3/4"	Ø51.3 +0.6 +0	Ø33.3	13.0	2.0	2.4
V11-375	VS10784701901	3-3/4"	Ø78.3 +0.6 +0	Ø47.8	19.3	2.5	3.2

## - Valve Disk

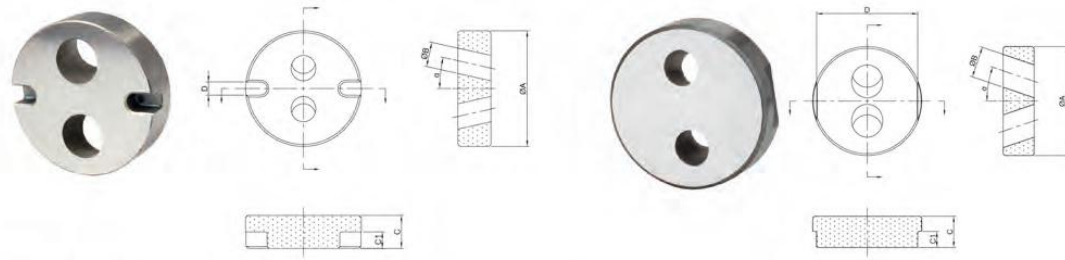

### Straight hole

Unit: mm

Stock No.	ΦA	ΦB	C	C1	D	α°
VD034002	34.9	3.2	12.8	6.4	5.3	9°
VD034003	34.9	6.4	12.8	6.4	5.3	9°
VD034004	34.9	9.5	12.8	6.4	5.3	9°
VD044003	44.5	14.3	12.7	6.4	5.1	10°
VD044008	44.5	3.2	12.7	6.4	5.2	9°
VD044009	44.5	4.8	12.7	6.4	5.2	9°
VD044010	44.5	6.4	12.7	6.4	5.2	9°
VD044011	44.5	9.5	12.7	6.4	5.2	9°
VD044012	44.5	12.7	12.7	6.4	5.2	9°
VD044026	44.5	9.5	12.7	6.4	5.1	12.5°
VD044030	44.5	12.7	12.7	6.4	5.1	12.5°
VD063006	63.5	9.5	19.1	7.0	6.9	0°

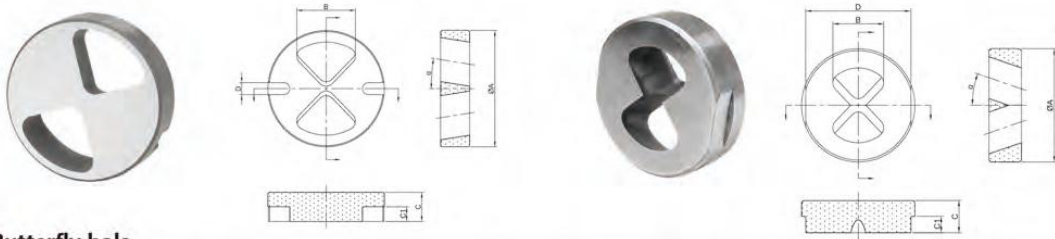

### Butterfly hole

Unit: mm

Stock No.	ΦA	ΦB	C	C1	D	α°
VD034007	34.9	16.8	12.8	6.4	5.3	9°
VD044013	44.5	21.4	12.7	6.4	5.2	0°
VD050009	50.8	25.6	12.7	6.4	5.2	9°
VD067001	67.3	35.4	12.7	6.4	4.8	8.5°
VD090002	90.5	42.6	19.1	11.2	7.0	24°

Unit: mm

Stock No.	ΦA	ΦB	C	C1	D	α°
VD044007	44.5	19.9	12.7	6.5	41.3	19°

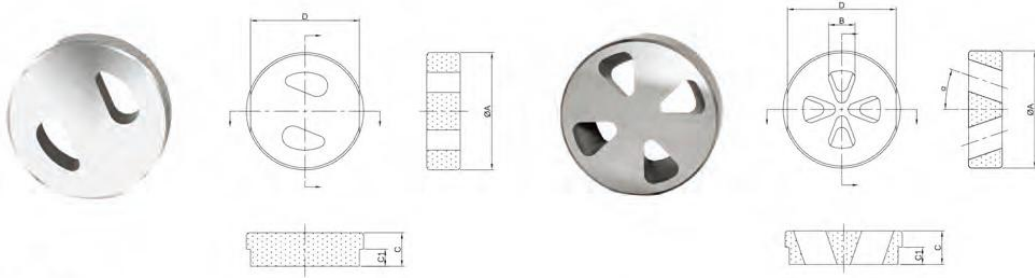

**Other shape**

Unit: mm

Stock No.	ΦA	C	C1	D
VD044028	44.5	12.7	6.5	41.3

Unit: mm

Stock No.	ΦA	ΦB	C	C1	D	α°
VD044006	44.5	10.0	12.7	6.5	41.3	19°

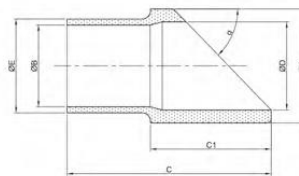

**Body sleeves**

Unit: mm

Stock No.	ΦA	ΦB	C	ΦD	ΦE	α
NX050011	44.5	31.8	79.8	34.3	36.5	45°

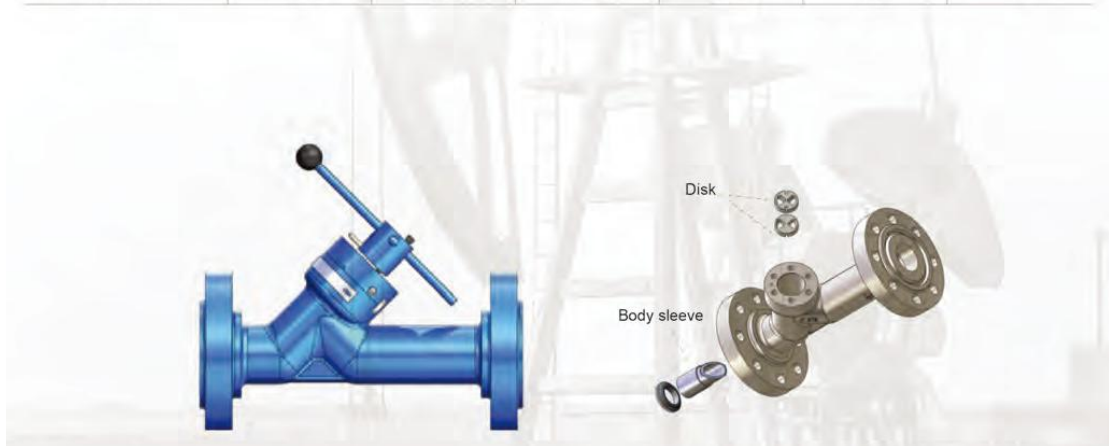

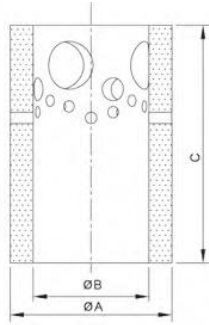

### Cages

Unit: mm

Stock No.	$\Phi A$	$\Phi B$	C
HX050007	70.8	50.8	104.0
HX076007	95.3	76.2	111.0

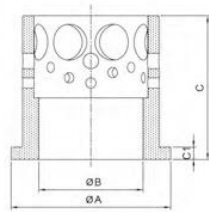

Stock No.	$\Phi A$	$\Phi B$	C
HX101001	155.5	101.6	140.0

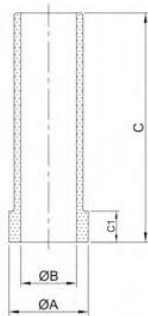

### Valve seat

Unit: mm

Stock No.	$\Phi A$	$\Phi B$	C	C1
HX023015	17.0	11.1	76.0	9.5
HX023016	24.2	17.5	40.0	9.5
HX023017	24.2	17.5	50.0	9.5
HX023018	24.2	17.5	60.0	9.5
HX023019	24.2	17.5	70.0	9.5
HX023020	24.2	17.5	80.0	9.5
HX023021	24.2	17.5	95.0	9.5